

Township 16 South, Range 56 East Northwest Quarter

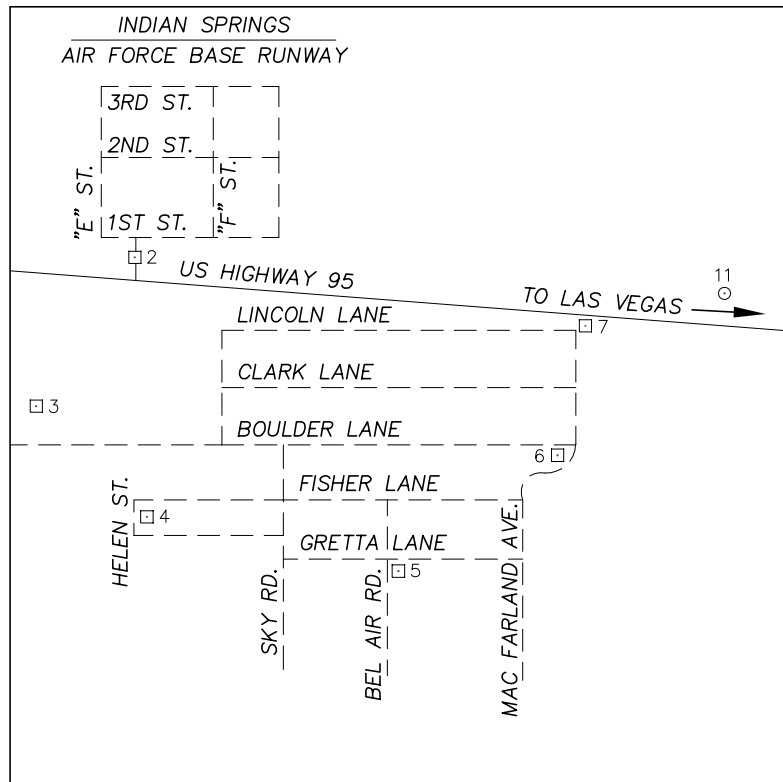

NORTH AMERICAN VERTICAL
DATUM OF 1988
- ALL ELEVATIONS IN METERS -

No.	STATION	ELEVATION (METERS)	DESCRIPTION
1			LOST 2003
2	C MAIN GATE	955.510	FND 2" DOME BRASS CAP, STAMPED "BM C MAIN GATE", IN TOP OF CURB AT SOUTH END OF ISLAND AT ENTRANCE TO AIR BASE FROM U.S. HIGHWAY 95.
3	6C66 8E6	964.638	FND RIVET AND SQUARE ALUMINUM PLATE IN CONCRETE BASE OF FLAG POLE, 2.3' SOUTH OF POLE, 12.6' WEST OF FRONT DOOR TO ELEMENTARY SCHOOL, 660' WEST OF SKY RD.
4	6C66 8SE6	972.894	FND RIVET AND SQUARE ALUMINUM PLATE, IN TOP OF CURB, NORTHEAST CORNER OF GRETTA LN. AND HELEN ST. NEAR THE PC OF GRETTA LN.
5	6C66 8SEE6	968.131	FND RIVET AND SQUARE ALUMINUM PLATE, IN TOP OF CURB, SOUTHEAST CORNER OF GRETTA LANE AND BEL AIR RD. NEAR THE PC OF GRETTA LN. AT THE CHURCH OF LATTER DAY SAINTS.
6	6C66 9W4	956.410	FND RIVET AND SQUARE ALUMINUM PLATE, IN TOP OF CURB, 9' EAST OF THE METRO SUBSTATION FLAG POLE, SOUTHWEST OF MAC FARLAND AVE. & BOULDER LN.
7	6C66 9NWW6	953.050	FND RIVET AND SQUARE ALUMINUM PLATE IN TOP OF CURB, SOUTHEAST CORNER OF MAC FARLAND AND THE SOUTH HWY. 95 FRONTAGE ROAD NEAR THE PC OF THE FRONTAGE ROAD. THIS CORNER IS PRESENTLY A SHELL GAS STATION AND FOOD MART.
8			LOST 2003
9	N 407 1983	957.625	FND USC&GS STAINLESS STEEL ROD, BM N-407, IN A WELL, 1.3 MILES SOUTHEAST OF INDIAN SPRINGS POST OFFICE, 1020' SOUTHEAST OF MILE MARKER 118, 660' SOUTHEAST OF THE SOUTHEAST CORNER OF A SEWER POND ON THE NORTH SIDE OF HIGHWAY #95, 128' NORTHEAST OF A CONCRETE HEADWALL ON THE NORTH SIDE HIGHWAY #95, 73' NORTH OF CENTERLINE NORTH BOUND LANE.
10	Q 407 1983	959.103	FND USC&GS STAINLESS STEEL ROD, BM Q-407, IN A WELL, 1.6 MILES NORTHWEST OF INDIAN SPRINGS POST OFFICE, 110' NORTH OF MILE MARKER 121, 145' NORTH OF THE CENTERLINE NORTH BOUND LINE, 190' SOUTHEAST OF THE A.C. CROSSOVER BETWEEN THE NORTHBOUND AND SOUTHBOUND LANES.

CLARK COUNTY VERTICAL CONTROL v.2003

CLARK COUNTY SURVEYOR'S OFFICE
5051 SOUTH PARADISE ROAD
LAS VEGAS, NEVADA 89119
(702) 455-0640

CONVERSION FACTOR:
METERS X $\left(\frac{3937}{1200}\right)$ = U.S. SURVEY FEET

REVISED 2003

SHEET
1 OF 2

16-56
NW

No.	STATION	ELEVATION (METERS)		DESCRIPTION	No.	STATION	ELEVATION (METERS)		DESCRIPTION
11	OC66 9NW6 2000	950.723	SE T	RIVET AND ROUND ALUMINUM PLATE IN THE NORTH END OF A CONC. HEADWALL, 9' NORTHEAST OF MILE MARKER 119, 45' NORTH OF CENTERLINE NORTHBOUND LANE, 90' SOUTHEAST OF THE EAST BLOCK WALL OF CASINO.	24				
12	OC66 8NWS 2000	954.488	SE T	RIVET AND ROUND ALUMINUM PLATE IN WEST END OF A CONC. HEADWALL, 485' WEST OF MILE MARKER 120, 30' NORTH OF CENTERLINE NORTHBOUND LANE, 5100' WEST OF THE PI OF HWY. #95 AND MACFARLAND AVE.	25				
13					26				
14					27				
15					28				
16					29				
17					30				
18					31				
19					32				
20					33				
21					34				
22					CLARK COUNTY VERTICAL CONTROL v.2003				
23					CLARK COUNTY SURVEYOR'S OFFICE 5051 SOUTH PARADISE ROAD LAS VEGAS, NEVADA 89119 (702) 455-0640		CONVERSION FACTOR: METERS X $\left(\frac{3937}{1200}\right)$ = U.S. SURVEY FEET		
					REVISED 2003	SHEET 2 OF 2	16-56 NW		